

Line pressure regulator HP 310

- single stage (4-port) max. 40 bar inlet pressure



Fittings and gauges optional

Description:

HP 310 is a single stage line pressure regulator and recommended especially for the control of high purity gases. HP 310 can be fitted with an inlet and outlet pressure gauge or can be combined with diaphragm shut-off valve HP 500 or diaphragm metering valve HP 503.

Application area:

For integration in small spaces/ instrumentation.

For integrating in pipe systems or (analytical) instruments.

High purity gas quality in science and research.

Due to special cleaning system also suitable for ECD application.

Technical details:

Body:	stainless steel 1.4404 electropolished or brass, nickel and matt chrome plated
Seat:	PCTFE
Diaphragm:	1.4435
Leakage rate: against atmosphere	10^{-8} mbar l/s He
Gas purity:	≤ 6.0
Max. Inlet pressure:	40 bar
Outlet pressure ranges:	0,5-3; 1-6; 1-10 bar
Operating temp.:	-20°C to +70°C
Gauge:	safety version to EN 837-1 KL1,6
Dimensions (wxhxd):	50 x 103 x 86
Weight:	605g

Hornung Quality standard

The company Hornung is certified to **DIN EN ISO 9001 and ISO 14001:2009**. All single parts are manufactured, assembled and tested by in-house production. The finished parts are therefore under all criteria of German quality control with 100% final inspection.

Hornung GmbH
Rathenaustraße 55, 63263 Neu-Isenburg

Phone: +49 6102 7883-70
Fax: +49 6102 7883-40

www.hornung.org
info@hornung.org

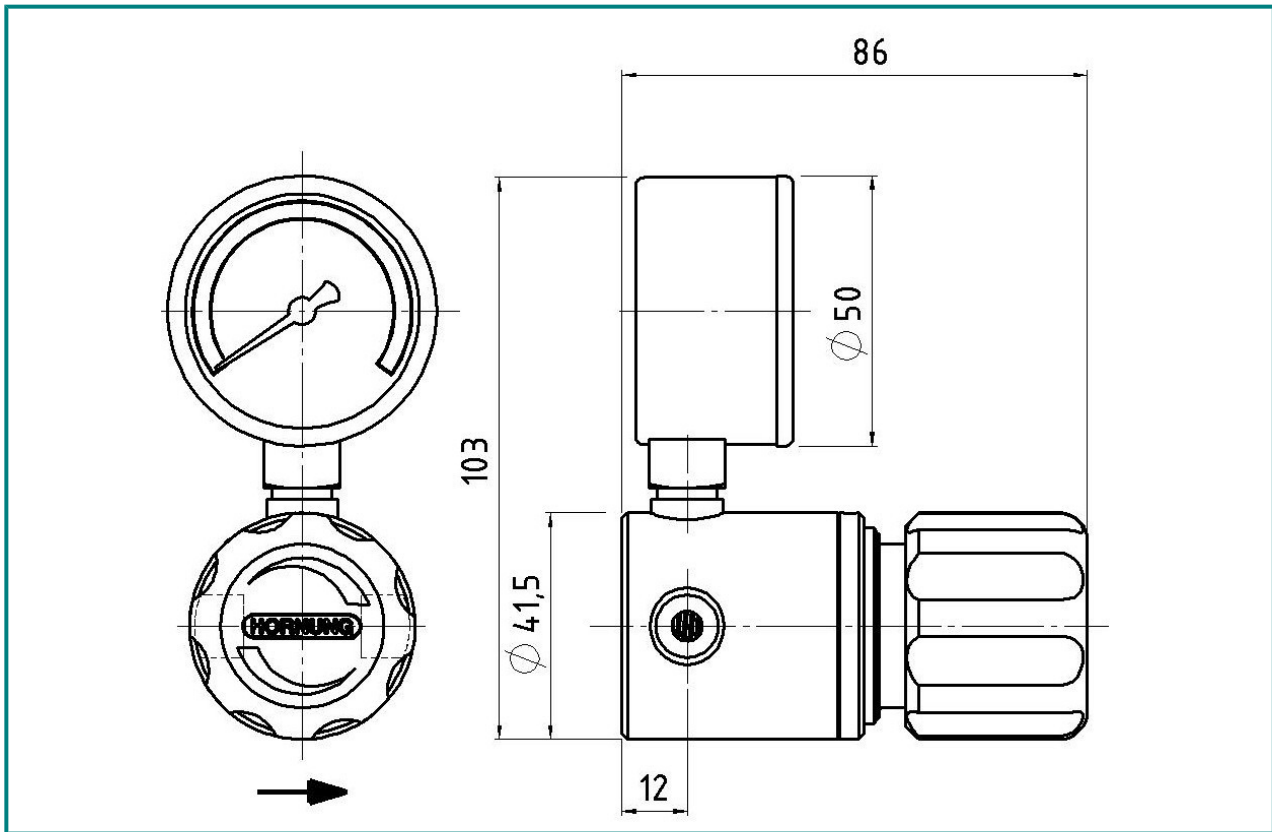

Accessories:

See total catalogue segment

- 5. Diaphragm shut-off and metering valve
- 7. Gauges, compression fittings and accessories

Ordering information:

Material:

- HP310** = stainless steel electropolished
- HP310MS** = brass, nickel and matt chrome plated

Inlet:

- 1 = from the left to the right
- 2 = from the right to the left

Outlet pressure ranges:

- 1 = 0,5 - 3 bar
- 2 = 1 - 6 bar
- 3 = 1 - 10 bar

Gauge:

- 1 = without gauges
- 2 = outlet gauge (working pressure)

Inlet – and Outlet Option:

- 0 = G 1/4" f
- 3 = compression fitting 3 mm
- 6 = compression fitting 6 mm
- 8 = compression fitting 8 mm
- 10 = compression fitting 10mm
- 12 = compression fitting 12mm

Order example:

HP310-	2	2	2	6	Medium
Type	Inlet	P2	Gauge	Option	Medium